



Installation guide

Preparation • Profiles • Sheet preparation and installation • After care



Please visit <https://claddingmonkey.co.uk/> for more information

Cladding Monkey wall cladding installation guide

This guide has been compiled to the best of our knowledge and is for guidance only. Cladding Monkey cannot be held responsible for any faults which may occur. For any further questions, please contact our technical department on:



<https://claddingmonkey.co.uk/>



01642 241777



sales@claddingmonkey.co.uk

Raising the bar, perfecting quality

Offering the complete hygienic cladding system that is strong, durable and long lasting even in the most extreme environments. hygienic and wet room environments, we offer a comprehensive range of high-quality sheets, ceiling planks and profiles that are available in a huge range of colours.

Cladding Monkey also offers a collection of high-performance adhesive and silicones with a range of unique benefits. This comprehensive adhesive and silicone collection are appropriate for a wide range of environments, including general purpose and sanitary use.

Important information prior to installation

It is essential to obtain a consistent appearance when installing hygienic wall cladding. Please adhere to these important guidelines:

- Ensure that the sheet production batch codes are the same - Never install sheets with different batch codes.
- Ensure the sheets are installed in the same orientation throughout. This guaranteeing that the grain of sheet is consistent. The protective film on the sheet should provide relevant guidance.
- Always store the sheets correctly. This will avoid warped sheets.

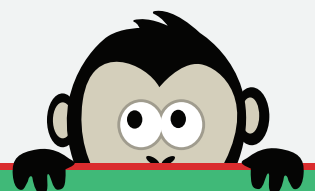

Please visit <https://claddingmonkey.co.uk/> for more information



Waterproof

Suitable for all wet room
Interior environments



Fire retardant

V-0 BS 476 Part 6
Class 1 BS 476 part 7



Easy to fabricate

Perfect for all fittings
and installations



Chemical resistant

Perfect for chemical
preparation environments



Exceedingly durable

Enhancing material performance,
service life and cost maintenance



Lightweight material

Easy to handle and install for
fittings and installations



Protective film

Superior quality product protection,
anti-fraud, branded protective film

Contents

Preparation 4

p.4 Surface preparation
p.4 Suitable substrates
p.4 Installation temperatures
p.4 Recommended tools and equipment
p.5 Recommended safety equipment
p.5 Safety information
p.5 Room preparation

Profiles 6

p.6 Profile range overview
p.7 Profile range overview
p.8 Installing the bottom sheet edge
p.8 Installing the ceiling and top sheet edge
p.9 Installing the joiner and transition profiles

Sheet preparation and installation 10

p.10 Planning layout
p.10 Sheet preparation
p.10 Product expansion
p.11 Thermoforming
p.11 Thermoforming benefits
p.12 Heat welding
p.12 Heat welding installation
p.12 Trimming off

After care 10

p.13 Hygienic wall cladding cleaning guide



Full technical specification data available



Surface preparation

- All surfaces must to clean, dry and free from all contamination.
- Any imperfections in the substrate should be filled.
- All electrical switches, power points etc. should be in a first fix state where possible.
- All pipes, bolts etc.... that are fixed through the sheet should have a minimum of 3mm expansion gaps and be sealed with the suitable Cladding Monkey silicone.

Suitable substrates

- Most flat, clean and secure surfaces are suitable. An adhesive test is recommended prior to installation.
- Painted surfaces are suitable. An adhesive test is recommended prior to installation.
- All plastered surfaces must be free from dust – PVA prior to installation

Installation temperatures

Our hygienic wall cladding sheets are recommended to be installed at approximately the same room temperature at which the area will be used when commissioned, this preventing warping of the product.

- Sheets must be stored flat in the room for approximately 24 hours to prior to the installation.

Recommended tools and equipment

The below list of tools and equipment will allow for a more efficient installation process:

- | | |
|-----------------|----------------------------|
| • Spirit level | • Laser level |
| • Tape measure | • Hacksaw |
| • Stanley knife | • Tenon saw |
| • Hammer | • Files (round and square) |
| • Rubber mallet | • Mixing paddle |
| • Chalk line | • Notch trowel |
| • Jig Saw | • Hole cutting drill bit |

Recommended safety equipment:

- All PPE that is relevant to the environment within which you are working.

Safety information

- The safety information on adhesive packaging/technical data must be strictly adhered to.
- All necessary precautions must be taken relevant to your working area.
- Ventilation within the working area is essential.

Room preparation

Prior to installation. Ensure all corners, doors and windows are free from contamination. This is essential as this process prevents installations issues that could be easily avoided.

- Once room preparation is complete, a datum line must be installed with a laser level for optimum accuracy. The datum line height (from sub-floor) should be calculated to allow for the appropriate skirting height.
- Once all the calculations have been formed, you will need to visualise and plan the installation layout. This minimises the number of profiles used in the system and makes the overall installation method more efficient.

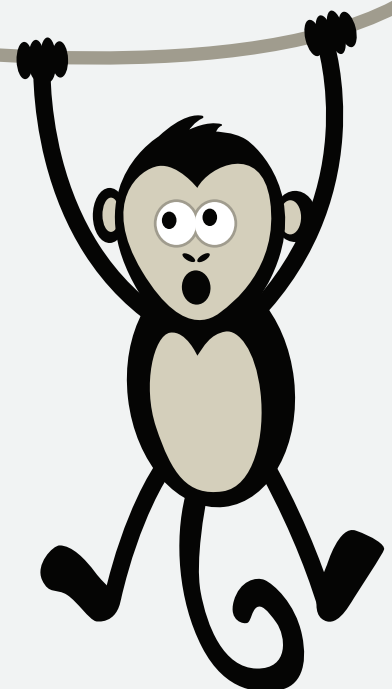

Joiner and transition profiles

1 part

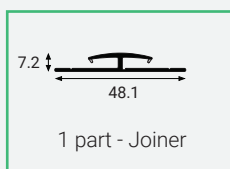

2 part

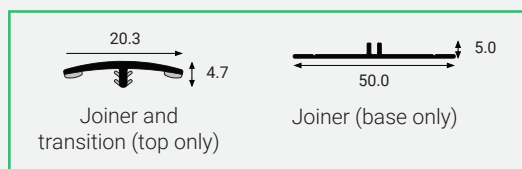

Joiner profiles are used to create a watertight seal between the sheet and the ceiling/flooring.

Capping and transition profiles

1 part

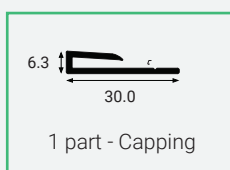

2 part

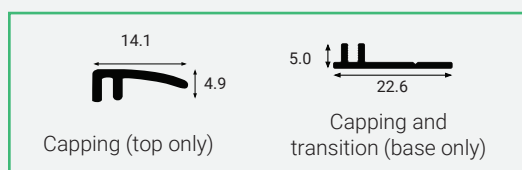

Capping profiles are used to create a watertight seal between the sheet and the ceiling/flooring.

Corner profiles

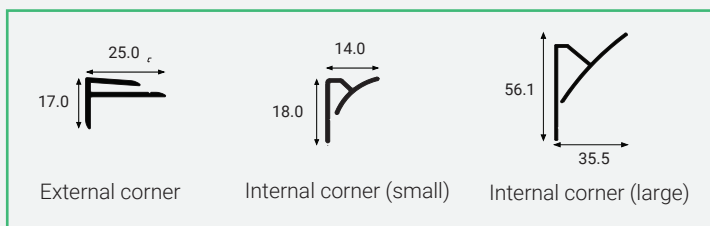

Corner profiles are used to create a watertight seal between two corner sheets.

Internal angle profiles

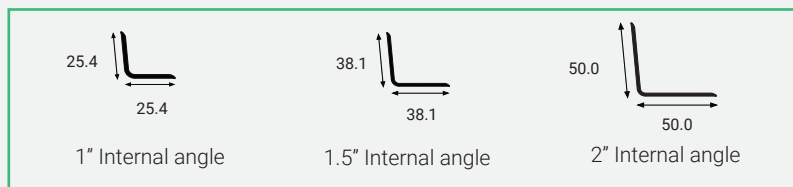

Internal angle profiles are used on embedded corners to create a watertight corner seal.

External angle profiles

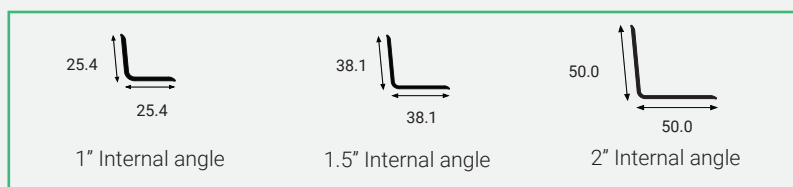

External angle profiles are used on extruded corners to create a watertight corner seal.

Installing the bottom of the sheet edge

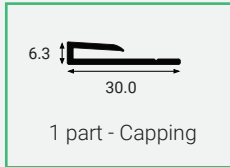

Step 1:

Connect the 1 part - capping profile to the wall with adhesive, screws or tacks. The use of silicone is important at the sheet base where wet cleaning may occur i.e. cleaning the floor. This 1 -part J profile is only available in white.

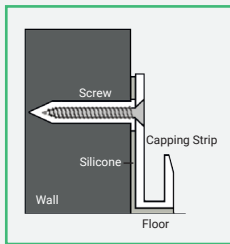

Step 2:

Additional silicone may be applied to the top and bottom edges of the profile to ensure a watertight seal.

Installing the ceiling and top of the sheet edge (diagram 2)

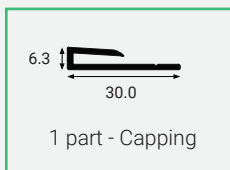

Step 3:

Connect the 1 part - capping profile to the top of the wall using the same principles in Step.1.

You may choose to fit the sheet tight to the ceiling (allow 3mm for expansion) and seal using the appropriate coloured silicone instead.

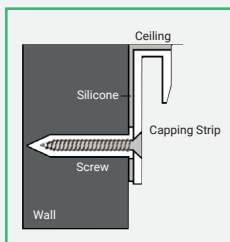

Please note: When installing ceiling cladding, please consider the installation method prior to installing the top of the edge (please see page 13).



Installing the joiner and transition profiles

Cladding Monkey wall cladding to flooring (skirting detail)

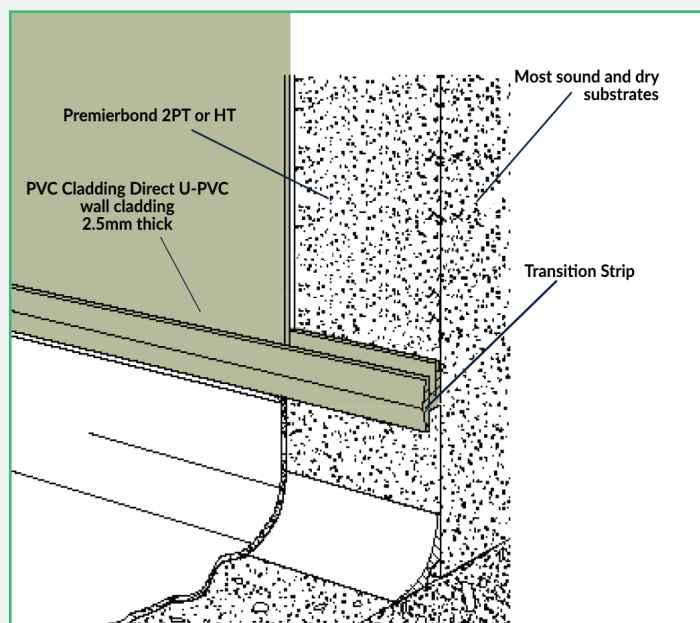

1 part

2 part

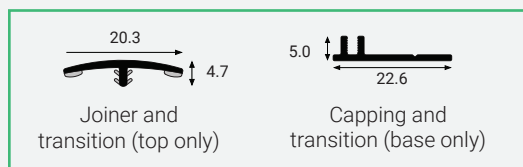
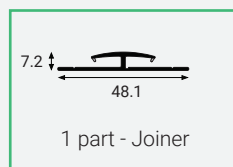

Step 1:

The capping and transition base profile should be fitted onto the wall using Premierbond 2PT or HT. Time must be allowed for the adhesive to set, otherwise the weight of the sheet once applied could dislodge the profile.

Step 2:

Once the capping and transition base profile is fitted, sit the bottom edge of the sheet onto the profile and apply pressure to the sheet to adhere it to the wall. We recommend the joiner and transition top part is fitted once the job is complete and the protective film has been removed.

Step 3:

To create a secure fixing, with moderate force use a rubber mallet or the palm of your hand to tap the top of the profile.

Planning layout

Planning the layout prior to installation is essential.

- This preparation helps minimise the number of profiles used in the system.
- Before installing the sheets, plan out where the profiles will fall in the cladding operation.
- Ensure you have all the correct profiles, equipment and adhesives prior to installation.

Sheet preparation

- Place the sheet onto the workbench, examine for damage prior to preparing the measurements. Once you are content with the quality of the sheet, on the protective film side mark the datum line using a pen. Be careful when marking as too much force may cause damage to the surface of the sheet.
- Using the recommended safety equipment and tools, cut the sheet to size. Then remove the protective film approximately 50mm from each edge. The uncovered edges will allow space for the sheet to be fitted into the profiles. Make sure you do not fully remove the protective film until the installation process is fully complete.
- Test the sheet by holding it up against the substrate, ensuring you have 3mm expansion gap on all sides.
- Once the sheet has been tested, place the sheet protective film side down onto the workbench. Clean off any contamination from the substrate and glue.

Adhesive Recommendations: Premierbond 2PT adhesive is recommended for all installations in wet areas such as bathrooms, kitchens and gymnasiums.

- Adhere to the adhesive packaging for directions of use.
- Apply the adhesive to the back of the sheet, using a 6mm notched trowel smoothing outwards from the centre. For flat plastered walls you can use a 3mm notched trowel.
- The working time of the adhesive is approximately 40 minutes with the initial cure being 20 minutes.
- Prepare the following sheets in the above process, for welding advice please see page 12.

Product expansion

Cladding Monkey hygienic wall cladding should be installed to within 3mm of inflexible supports such as door frames, ceilings and skirting. The 3mm gap will allow for expansion and contraction. During installation if measurements are inaccurate the sheet may not be adjacent to the ceiling or corner line, this creating exposed edges.

Accordingly, if there are any exposed edges of the sheet, Cladding Monkey offers a comprehensive range of colour matched silicones. This can be used to seal any exposed edges, ensuring a professional finish.

Thermoforming

Cladding Monkey recommends the use of thermoformed internal / external corner detail when installing the sheets. This is achieved by heating the sheet on a thermoformer unit and manually forming the sheet to the desired angle.

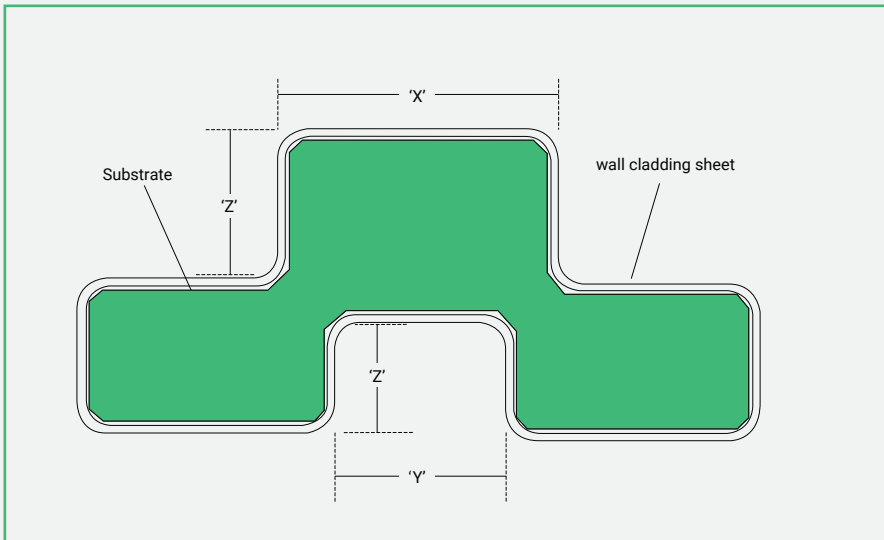

Please ensure you follow the installation guidelines carefully to ensure best results.

'X' - External to External corners = + 6mm

'Y' - Internal to Internal corners = - 6mm

'Z' - Internal to External / or External to Internal corners - Is the same measurement as substrate

All measurements to be marked on the protective film side of the sheet.
The above guidelines are for guidance purposes only.

Thermoforming benefits

- Adaptive installation method suitable for all areas
- Low use of tooling
- Visually pleasing appearance
- Accurately shaped corners
- Fully sealed hygienic finish

Heat welding

- Ensure the weld rod and the joint gap are clean and free from contamination.
- The use of a welding gun is recommended to enhance overall efficiency.
- Heat welding is recommended at approximately the same room temperature at which the area will be used this preventing warping of the product.
- The use of heat will soften the weld rod and the sheet edge to fuse these materials together.

Heat welding installation

- As you place the sheets on the wall, allow 1.5mm gap between each sheet for the weld rod.
- Ensure the sheet and weld rod are clean and free from contamination.
- Set up the welding gun until the temperature/speed is adequate.
- A test weld is advised prior to beginning the installation to ensure the temperature/weld speed is correct.
- Once the weld has cooled down it may be trimmed flush, please see below:

Trimming off

- The process must be done carefully as the smooth wall cladding surface will highlight any imperfections.
- Pre-cutting must be done carefully as taking too much off may result in an imperfect finish.
- It is advised that no more than half of the excess weld rod is pre-cut. This is to avoid the weld rod descending into the joint once cooled.
- Allow the weld rod the fully cool down before completing the final trimming.

Hygienic wall cladding cleaning guide

Initial cleaning preparation

Once all sheets and profiles are installed, allow enough time for the adhesives/sealants to fully cure prior to cleaning. Begin by removing the protective film from sheets and profiles and clean all surfaces with an anti-static solution or anti-static cleaning wipes.

Regular cleaning

When cleaning the sheets, we recommend using a soft cloth with a mild soap/detergent. The temperature of the water or cleaning solution should not exceed 60°C. To reduce the build-up of static, we recommend cleaning the sheets with an anti-static solution or anti-static cleaning wipes.

For stubborn stains, we recommend using an alkaline cleaner in combination with a soft cloth. Pressure cleaning with hot water may be used. However, to prevent damage, ensure that the pressure nozzle is a minimum of 2 feet (600mm) away from the sheets surface.

Please be aware some cleaning products containing abrasives or solvents may adversely affect the sheets. For general use in hygienic environments, we recommend thoroughly cleaning the sheets at least once per week.

Contact us:

Cladding Monkey
36 Cumberland Road
Middlesbrough
TS5 6HZ

Email us: sales@claddingmonkey.co.uk

Call us: 01642 241777

Opening times

Mon-Thu: 08:30 - 16:00

Fri: 08:30 - 3:30

